

The Nyrius logo is displayed in white text on a blue rectangular background.

INSTRUCTION MANUAL MANUEL D'INSTRUCTION



HDMI
HIGH SPEED

Full HD
1080p

ARIES MATRIX

Multiple Input Wireless HD Transmitter

Émetteur HD sans fil à entrées multiples

FCC STATEMENT

This device complies with part 15 of the FCC rules. Operation is subject to the following two conditions:

- (1) this device may not cause harmful interference, and
- (2) this device must accept any interference received, including interference that may cause undesired operation.



WARNING:

This equipment has been tested and is found to comply with the limits for a Class B digital device, pursuant to Part 15 of the FCC Rules. These limits are designed to provide reasonable protection against harmful interference in a residential installation. This equipment generates, uses and can radiate radio frequency energy and, if not installed and used in accordance with the instructions, may cause harmful interference to radio communications. However, there is no guarantee that interference will not occur in a particular installation. If this equipment does cause harmful interference to radio or television reception, which can be determined by turning the equipment off and on, the user is encouraged to try to correct the interference by one or more of the following measures:

- Reorient or relocate the receiving antenna
- Increase the separation between the equipment and receiver
- Connect the equipment into an outlet on a circuit different from that to which the receiver is connected
- Consult the dealer or an experienced radio/TV technician for help

WARNING:

Changes or modifications not expressly approved by the party responsible for compliance with the FCC Rules could void the user's authority to operate this equipment.

IC STATEMENT

Industry Canada Statement CAN ICES-3(B)

This device complies with Industry Canada licence-exempt RSS standard(s). Operation is subject to the following two conditions:

- (1) this device may not cause interference, and
- (2) this device must accept any interference, including interference that may cause undesired operation of the device.

SAFETY INFORMATION

1. Read all instructions.
2. Keep these instructions.
3. Heed all warnings.
4. Follow all instructions.
5. Do not use this apparatus near water.
6. Clean only with a dry cloth.
7. Do not block any ventilation openings. Install in accordance with the manufacturer's instructions.
8. Do not install near any heat sources such as radiators, heat registers, stoves, or other apparatus (including amplifiers) that produce heat.
9. Do not defeat the safety purpose of the polarized or grounding-type plug. A polarized plug has two blades with one wider than the other. A grounding type plug has two blades and a third grounding prong. The wide blade or the third prong are provided for your safety. If the provided plug does not fit into your outlet, consult an electrician for replacement of the obsolete outlet.
10. Protect the power cord from being walked on or pinched particularly at plugs, convenience receptacles, and the point where they exit from the apparatus.
11. Only use attachments/accessories specified by the manufacturer.
12. Unplug this apparatus during lightning storms or when unused for long periods of time.
13. Refer all servicing to qualified service personnel. Servicing is required when the apparatus has been damaged in any way, such as power-supply cord or plug is damaged. Liquid has been spilled or objects have fallen into the apparatus, the apparatus has been exposed to rain or moisture, does not operate normally, or has been dropped.
14. Apparatus shall not be exposed to dripping or splashing, and that no objects filled with liquids, such as vases, shall be placed on the apparatus.
15. The battery shall not be exposed to excessive heat such as sunshine, fire or the like.
16. The direct plug-in adapter is used as disconnect device, the disconnect device shall remain readily operable.
17. **WARNING:** To reduce the risk of fire or electric shock, do not expose this apparatus to rain or moisture.



This marking indicates that this product should not be disposed with other household wastes throughout North America. To prevent possible harm to the environment or human health from uncontrolled waste disposal, recycle it responsibly to promote the sustainable reuse of material resources. To return your used device, please use the return and collection systems or contact the retailer where the product was purchased. They can take this product for environmental safe recycling.

TABLE OF CONTENTS

FCC Statement2

IC Statement2

Safety Information.....3

What’s Included4

Buttons and Connections5

Connecting7

 Connecting your Transmitter/Receiver6

Setup.....8

 Battery Installation for Remote8

 Turning the Transmitter and Receiver ON9

 TV Settings.....9

 HD Device Setup.....10

 Extend Mode.....11

 Understanding the LEDs.....11

Troubleshooting.....12

Specifications14

Nyrius Warranty.....15

WHAT’S INCLUDED

- Wireless Transmitter
- Wireless Receiver
- 2 x IR Sensor Extenders
- 2 x 5ft HDMI Cables
- 2 x 100-240V AC Power Adapters
- Quick Start Guide
- 1 Year Warranty
- Lifetime Customer Support

DISCLAIMERS

Maximum line of sight for transmission range is 66 feet. Obstacles may decrease transmission distance.

This unit should only be used with the power adapters included in this package.

We reserve the right to change models, configuration, or specifications without notice or liability. Product may not be exactly as shown.

©2013 NYRIUS®. All rights reserved. NYRIUS®, the NYRIUS® logo, and other NYRIUS® marks may be registered. All other Trademarks are the property of their respective owners.

BUTTONS & CONNECTIONS

TOP

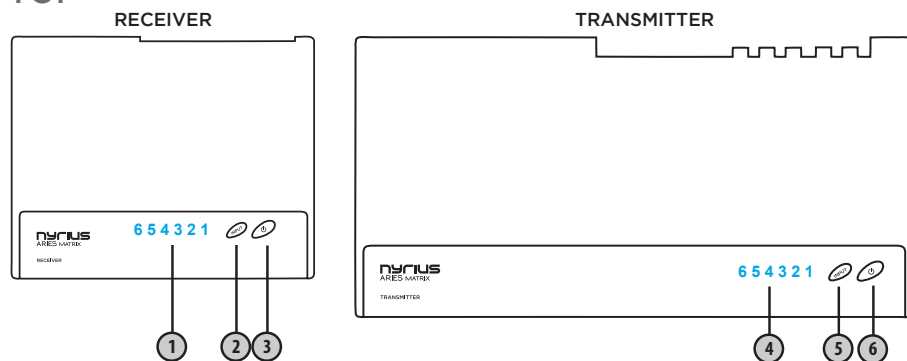

BACK

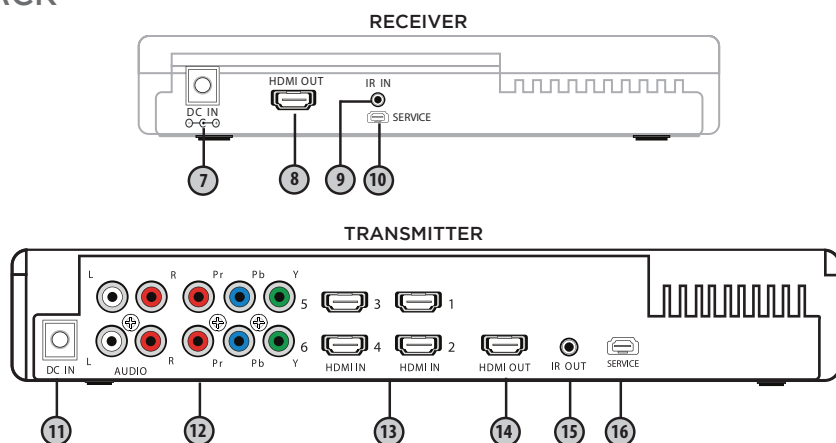

1 & 4	Input Selections	9 & 15	IR OUT
2 & 5	Input Button	10 & 16	Service (Authorized NYRIUS Service Centre use only)
3 & 6	Power Button with LED Indicator	12	Component Video IN/ Audio L/R IN
7 & 11	DC Power Input	13	4 x HDMI IN Ports
8 & 14	HDMI OUT Port		

BUTTONS & CONNECTIONS

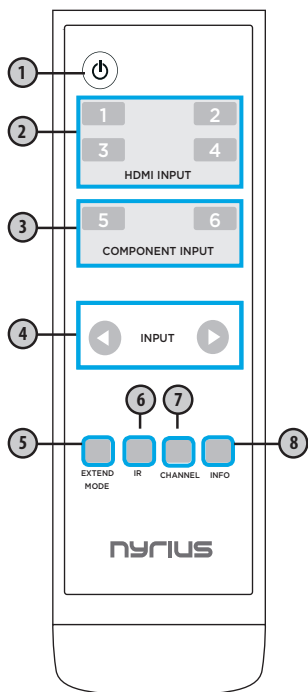

1	Power Button Turn Transmitter/ Receiver ON/OFF	5	Extend Mode (1080i or lower) Adjust the maximum wireless range between 65ft and 100ft
2	HDMI Input Toggle between 4 HDMI input sources	6	IR Press if remote extender is unresponsive (38KHz/47KHz/58KHz)
3	Component Input Toggle between 2 Component Video input sources	7	Channel Change wireless channel manually
4	Input Cycle through all six au- dio/video sources back- wards or forwards	8	Info Displays current system settings in On-Screen Display (OSD)

CONNECTING

NOTE: Maximum line of sight transmission range is 66 feet.
Obstacles may decrease transmission distance.

1. Connect the power supply to the Receiver.
2. Connect the IR Sensor Extender and place it in front of the IR window of the media source. (As shown in diagram below)

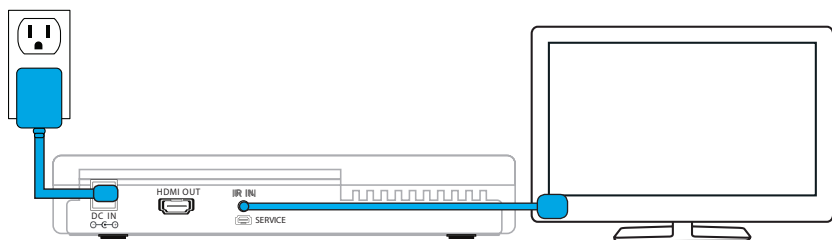

1. Connect the HDMI cable from the Receiver to the media source.

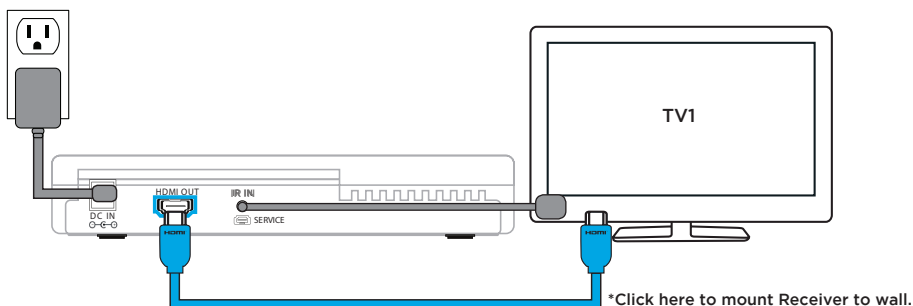

1. Connect the power supply to the Transmitter.
2. Connect IR Blaster Extender and place each sensor in front of the IR window of each nearby audio/video device. (As shown in diagram below). *Obstacles may decrease transmission distance.

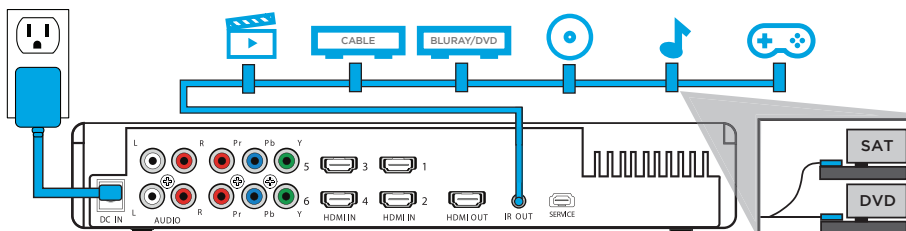

CONNECTING

1. The transmitter has four HDMI inputs for HD devices, such as PS3™, XBOX 360, Blu-ray Players, cable boxes & HDMI enabled laptops & desktops. You can also connect an HDMI cable from the HDMI out to a media source (i.e. TV or projector).

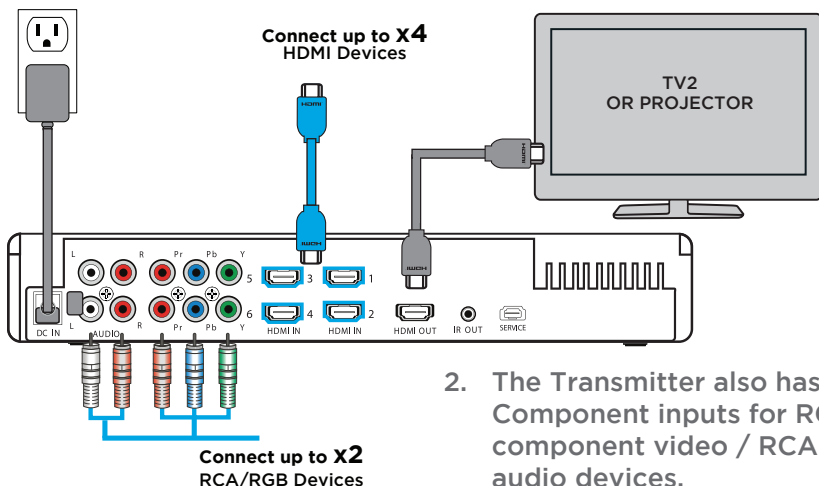

2. The Transmitter also has two Component inputs for RGB component video / RCA audio devices.

SETUP

1. Gently pull on the tab (following the arrow) on the battery compartment of the remote control.
2. Pull UP to release the battery compartment cover.
3. Place the two AAA batteries into the remote control, being sure to follow the polarity markings indicated in the compartment.
4. Replace the battery compartment cover.

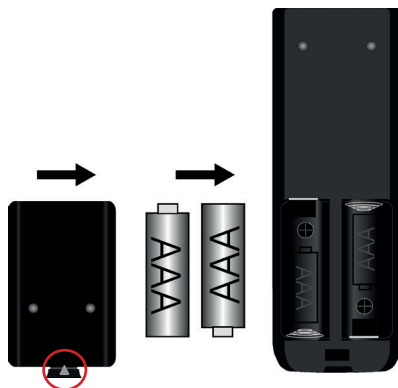

SETUP

1. Turn the Transmitter and Receiver ON (LED will be BLUE).
2. Press the POWER button on the Transmitter/Receiver or you can press the POWER button on the Remote control.

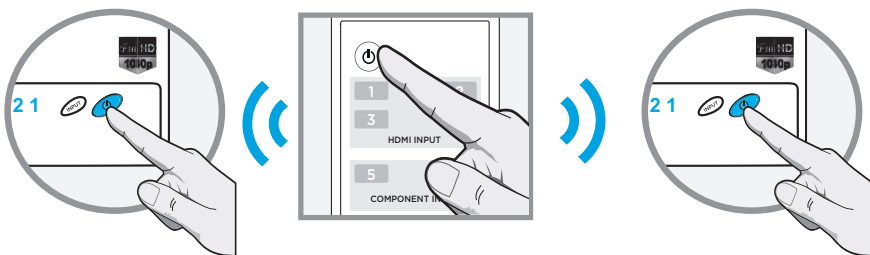

1. On your TV, go to the SOURCE menu, then select the correct input.
2. On the transmitter/receiver remote, select the corresponding HDMI/Composite video input. **Allow 8-10 seconds to connect.**

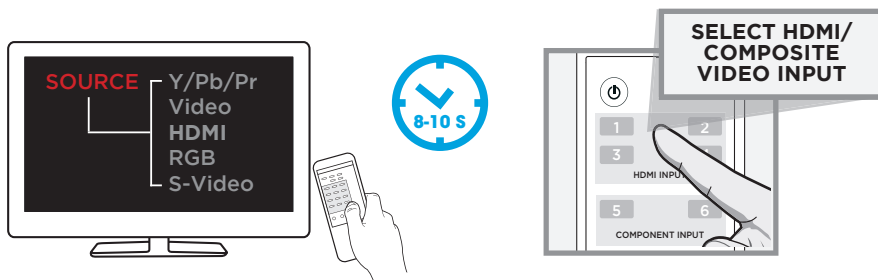

- Please allow a few seconds for wireless connection

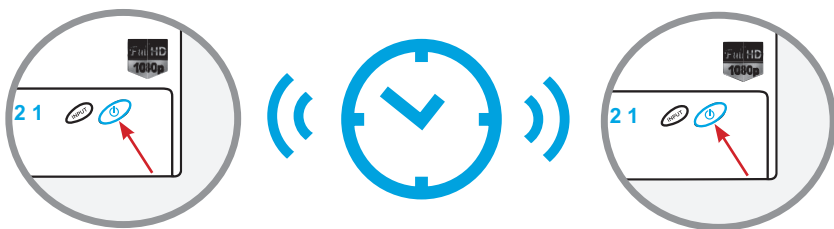

Interference may come from other wireless devices using a 5GHz band. If this occurs, press CHANNEL button 2 times to change the wireless channel.

SETUP

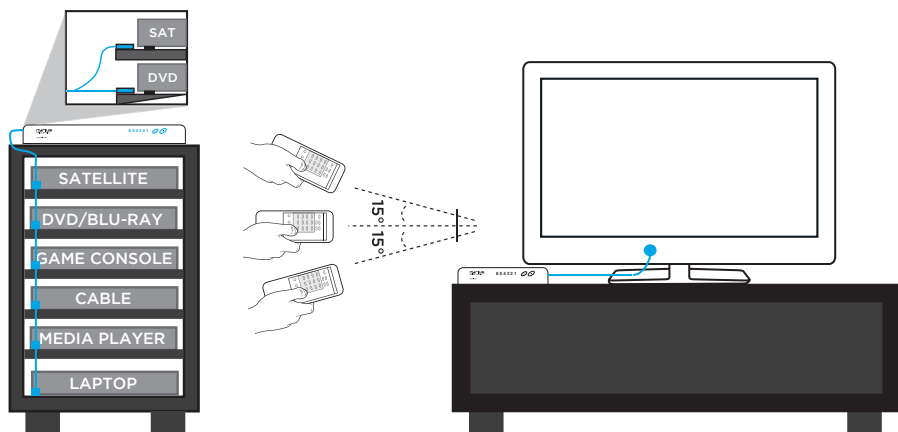

1. Each infrared (IR) sensor extender should be in front each HD device(s) you are using.
2. When the infrared (IR) sensor extender is connected, it relays infrared commands from your remote control to the device. Allowing you to control your AV devices by pointing your remote control to the TV instead of to your AV equipment.
3. If remote extender is unresponsive, point transmitter/receiver remote control at either transmitter or receiver and press IR button on remote to select a different frequency (38KHz/47KHz/58KHz).

Interference may come from other wireless devices using a 5GHz band. If this occurs, press CHANNEL button 2 times to change the wireless channel.

- If connection is not established after a few seconds, the signal might be lost or the transmitter is out of range.
- Verify the range and adjust or shorten the distance between your HDTV and the transmitter & receiver.
- The maximum video transmission range for 1080p content (EXTEND MODE off) is up to 66 feet in line of sight (LOS);
- The maximum video transmission range for 1080i content (EXTEND MODE on) is up to 100 feet (Line of Sight). The minimum range is 6.5 feet.

SETUP

EXTEND MODE

To be used for multi-room audio/video transmission or transmission between different floors¹. Press the "EXTEND MODE" button on the remote control for a longer-range audio/video transmission.

¹Applicable only with resolution of 1080i or lower. Cannot be used if transmitting 1080p content.

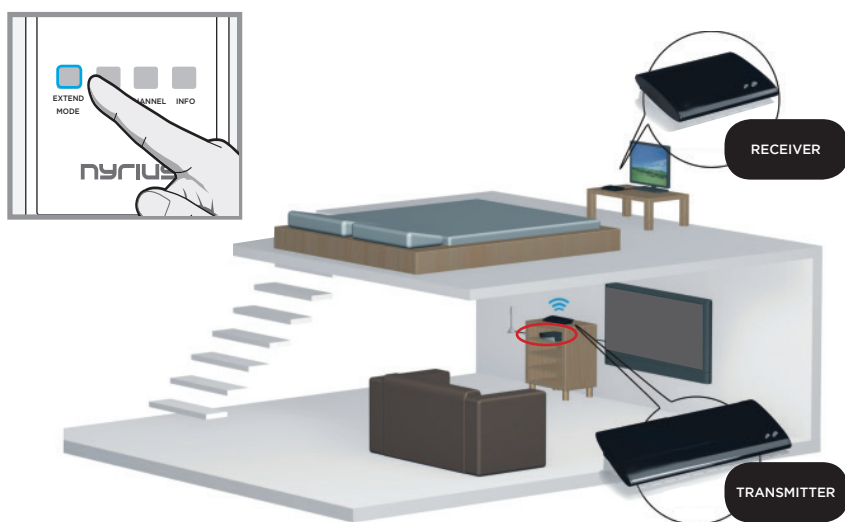

UNDERSTANDING THE LEDS

SOLID BLUE	LINKED	<ul style="list-style-type: none">• Transmitter/Receiver are linked
FLASHING BLUE	SEARCHING	<ul style="list-style-type: none">• Transmitter/Receiver not in range• No HDMI input connected
SOLID RED	STANDBY	<ul style="list-style-type: none">• Transmitter/Receiver in power saving mode

TROUBLESHOOTING

ISSUE	LED	POSSIBLE SOLUTION
Transmitter/ Receiver LEDs are not ON	<ul style="list-style-type: none"> • NO LEDs 	<ul style="list-style-type: none"> • Confirm that Transmitter/ Receiver are correctly and firmly connected and plugged into power outlet.
No video is displayed	<ul style="list-style-type: none"> • POWER LED FLASHING BLUE • OSD SHOWING "Searching available channels" 	<ul style="list-style-type: none"> • Transmitter/Receiver may require a few seconds to connect. • Ensure the correct HDMI/ Composite video input is selected on your TV. • Please confirm that your HDMI/ Composite video cables are properly connected. • Check that your video resolution with device in HDMI input is set 1080p, 1080i, 720p, 576p, or 480p • Enable Extend Mode
	<ul style="list-style-type: none"> • POWER LED IS SOLID BLUE + INPUT LED FLASHING BLUE • OSD SHOWING "No signal" 	<ul style="list-style-type: none"> • Check that proper cables are connected between the transmitter and your AV devices. • Ensure your source devices connected to the Transmitter are powered on. • Ensure the proper cables are connected between the receiver and your 2nd HDTV near the Receiver. • Enable Extend Mode
Poor picture quality or intermittent video	<ul style="list-style-type: none"> • POWER LED IS SOLID BLUE + INPUT LED SOLID BLUE 	<ul style="list-style-type: none"> • Check that your video resolution with device in HDMI OR Component input are set to supported resolutions. • Press CHANNEL 2 times on remote control to manually change the wireless channel. • Ensure the transmission distance is less than 66 feet (LOS). • Enable Extend Mode

TROUBLESHOOTING

ISSUE	LED	POSSIBLE SOLUTION
No Audio	<ul style="list-style-type: none"> • POWER LED IS SOLID BLUE + INPUT LED SOLID BLUE 	<ul style="list-style-type: none"> • Confirm the TV's volume is properly set and not on "MUTE". • Confirm the audio connectors are properly connected. • Ensure the bit rate of audio from the source device can be supported.
No Supported Video /Audio on EXTEND MODE.	<ul style="list-style-type: none"> • POWER LED IS SOLID BLUE + INPUT LED SOLID BLUE 	<ul style="list-style-type: none"> • Check the HDMI output setting of Source device, set HDMI output format to Auto mode instead of 1080p. • Check that your video resolution with device in HDMI OR Component input are set to supported resolutions.
Unable to control Source device with IR Extenders	<ul style="list-style-type: none"> • POWER LED IS SOLID BLUE + INPUT LED SOLID BLUE 	<ul style="list-style-type: none"> • Make sure IR Extenders are placed properly in front of source device's IR Sensor. • See page 10 for IR Extender placement. • Change IR frequency; press IR button on remote to select a different frequency (38KHz/47KHz/58KHz)

SPECIFICATIONS

Supported Video Resolution	1080p, 1080i, 720p, 576p, 576i, 480p, 480i
Audio Formats	Uncompressed 5.1 PCM, DTS, Dolby Digital Surround Sound
Ports & Interfaces	Transmitter: 4x HDMI in, 1x HDMI out (loop-through), 2x Component in
Wireless Range	Regular Mode: 66 feet @ 1080p (clear line of sight); Extend Mode: 100 feet @ 1080i/720p (clear line of sight)
Operating Frequencies	4.9-5.9 GHz
System Latency	Zero latency (<1ms)
Antenna	High Performance Internal Antennas
IR Function	47K, 58K, 38K
Compatible TV Systems	Any high-definition television including popular models from these manufacturers: Samsung, Sony, Sharp, Vizio, Hitachi, JVC, LG, Mitsubishi, Panasonic etc.
Certification	FCC, ICES, UL
Power Supplies	5V DC
Wireless Technology	GigaXtreme Technology
System Requirements	Any laptop or desktop system containing an HDMI port including popular models from these manufacturers: Alienware, Lenovo, Dell, HP, Acer, etc.
Control	Remote control or Toggle Button
Transmitter Dimensions	5.8x11.6x1.8 inches 149x295x45.5mm (LxWxH)
Receiver Dimensions	5.7x7.1x1.3 inches 145x181x33mm (LxWxH)



Support & Online live web chat

[NYRIUS.COM/SUPPORT](https://nyrius.com/support)

WARRANTY

Thank you for choosing NYRIUS® Consumer Electronics Products!

NYRIUS gives the following express warranty to the original consumer purchaser or gift recipient for this NYRIUS product, when shipped in its original container and sold or distributed by NYRIUS or by an Authorized NYRIUS Dealer: NYRIUS warrants that this product is free, under normal use and maintenance, from any defects in material and workmanship. If any such defects should be found in this product within the applicable warranty period, NYRIUS shall, at its option, repair or replace the product as specified herein. Replacement parts furnished in connection with this warranty shall be warranted for a period equal to the unexpired portion of the original equipment warranty.

This warranty shall not apply to:

- A. Any defects caused or repairs required as a result of abusive operation, negligence, accident, improper installation or inappropriate use as outlined in the owner's manual.
- B. Any NYRIUS product tampered with, modified, adjusted or repaired by any party other than NYRIUS or NYRIUS's Authorized Service Centres.
- C. Damage caused or repairs required as a result of the use with items not specified or approved by NYRIUS including but not limited to head cleaning tapes and chemical cleaning agents.
- D. Any replacement of accessories, glassware, consumable or peripheral items required through normal use of the product including but not limited to earphones, remote controls, AC adapters, batteries, stylus, trays, filters, cables, paper, cabinet, cabinet parts, knobs, buttons, baskets, stands and shelves.
- E. Any cosmetic damage to the surface or exterior that has been defaced or caused by normal wear and tear.
- F. Any damage caused by external or environmental conditions, including but not limited to transmission line/power line voltage or liquid spillage.
- G. Any product received without appropriate model, serial number and CSA /cUL / cULus /cETL /cETLus markings.
- H. Any products used for rental or commercial purposes.
- I. Any installation, setup and/or programming charges.

Should this NYRIUS product fail to operate during the warranty period, warranty service may be obtained upon delivery of the NYRIUS product together with proof of purchase and a copy of this LIMITED WARRANTY statement to an Authorized NYRIUS Service Centre. In-home warranty service may be provided at NYRIUS discretion on any NYRIUS television with the screen size of 40" or larger. This warranty constitutes the entire express warranty granted by NYRIUS and no other dealer, service centre or their agent or employee is authorized to extend, enlarge or transfer this warranty on behalf of NYRIUS. To the extent the law permits, NYRIUS disclaims any and all liability for direct or indirect damages or losses or for any incidental, special or consequential damages or loss of profits resulting from a defect in material or workmanship relating to the product, including damages for the loss of time or use of this NYRIUS product or the loss of information. The purchaser will be responsible for any removal, reinstallation, transportation and insurance costs incurred. Correction of defects, in the manner and period of time described herein, constitute complete fulfillment of all obligations and responsibilities of NYRIUS Electronics to the purchaser with respect to the product and shall constitute full satisfaction of all claims, whether based on contract, negligence, strict liability or otherwise.

1 YEAR PARTS & LABOUR WARRANTY PERIOD

TO OBTAIN THE NAME AND ADDRESS OF THE NEAREST AUTHORIZED NYRIUS SERVICE CENTRE OR FOR MORE INFORMATION ON THIS WARRANTY CONTACT NYRIUS SUPPORT:

- Support: nyrius.com/support
- Website: nyrius.com
- By mail: NYRIUS Customer Service,
4080 Montrose Road, Niagara Falls, ON, L2H 1J9

NYRIUS is a registered trade-mark of Circus World Displays Limited 08.2013

NOTES